

The background of the entire page is a photograph of the St. Louis Gateway Arch at night. The arch is illuminated and stands prominently against a dark blue sky. Below the arch, the city skyline of St. Louis is visible, with several skyscrapers lit up. The text is overlaid on this image.

**ACIL**  
AMERICAN COUNCIL OF  
INDEPENDENT LABORATORIES

# **Program Guide**

**79TH ANNUAL MEETING**

**St. Louis, MO**

**September 26 – 29, 2016**

**Hilton St. Louis at the Ballpark**

# Sponsors

## Gold



**Agilent Technologies**

Agilent Technologies



Pace Analytical Services, Inc.

**ThermoFisher**  
SCIENTIFIC

The world leader in serving science

Thermo Fisher Scientific

**Waters**

THE SCIENCE OF  
WHAT'S POSSIBLE.™

Waters Corporation

## Silver



LGC Standards

**MILLIPORE**  
**SIGMA**

MilliporeSigma



Perkin Elmer

**RESTEK**

Restek



Robert W. Baird & Co.

*The ACIL Code of Ethics below pays tribute to Earl Hess' legacy, enriching the laboratory community through his emphasis on ethics in business management, and establishing ACIL's Earl H. Hess Memorial Lecture Fund.*



AMERICAN COUNCIL OF INDEPENDENT LABORATORIES

## CODE OF ETHICS

*Each member of the association agrees that it is their policy to abide by the following code of ethics:*

- To cooperate in elevating and maintaining the professional status of independent scientific, engineering and testing firms and in securing recognition of the value of services rendered by them.
- To assert competency only in work for which adequate equipment and personnel are available or adequate preparation has been made.
- To have a clear understanding with the client as to the extent and kind of services to be rendered, especially in fields where different grades or characters of services are offered.
- To endeavour in reports to make clear the significance and limitations of findings reported.
- To safeguard reports as far as possible against misinterpretation or misuse, and to contend against such misinterpretation or misuse.
- To oppose and to refrain from incompetent and fraudulent inspection, sampling, analysis, testing, consultation, development and research work.
- To deal honestly and fairly in all business and financial matters with employees, clients and the public.

Dear ACIL friends,

Welcome to St. Louis, Missouri, the “Show-Me state,” and the 79th ACIL Annual Meeting! With its iconic Gateway Arch, St. Louis is commonly referred to as the “Gateway to the West” and “Home of the Blues,” referencing both its history of blues musicians and the city’s professional hockey team.

The ACIL staff and sections have put together an inspiring program for you this year, which will allow you opportunities to learn from peers and vendors in the industry and experience top-notch education to enhance business practices and laboratory operations. As part of the program, after the Annual Reception and Banquet at the Busch Stadium, you may enjoy a St. Louis Cardinals baseball game that night! We hope you enjoy the week and the many opportunities that are available to learn and to enjoy both the city and time with your peers.

I believe our annual meeting is an opportune venue to remind ourselves of and live ACIL’s mission “to enhance members’ success by providing advocacy, education, service and mutual support in addition to promoting quality, ethics, independence, and free enterprise”. This mission is as strong as our members’ commitment toward the same. Let’s continuously, as peers, work toward and create new ways to innovatively embrace our mission.

Since the ACIL Annual meeting in Miami, there has been a lot happening with the Board and Sections. There is one thought that continues to stand out in my mind, and that is, being active in ACIL *really* matters. Whether it is for you personally, ACIL, your company, or the industry in general, your active participation is what drives it. We have several new Board and Section Executive Committee members. Their desire to contribute to ACIL will lead to success and continue to progress the growth initiatives from which we have gained momentum. We will continue to see challenges in our industry, but with the ACIL family, we will remain a strong and relevant organization.

I want to express my gratitude to all of the dedicated ACIL staff and members who have generously given their time to put this terrific program together and for your continued support each year. I believe this is going to be one of those ACIL Annual Meetings that we will all remember and be thankful we attended.

Enjoy the meetings, time with friends, and some St. Louis hospitality!

Best regards,

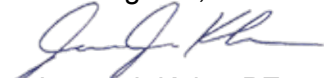

James J. Kuhn, PE  
ACIL Chair

---

# Schedule (subject to change)

## Monday, September 26, 2016

8:00am – Noon	Board of Directors Meeting	
9:30am – 5:00pm	Registration Open <i>Sponsored by Restek Corporation</i>	
10:00am – Noon	ILI Analyst Enrichment Work Group Meeting	
1:00pm – 5:00pm	Section Breakouts	Food Sciences
1:00pm – 5:00pm	Section Breakouts <i>Sponsored by Pace Analytical Services</i>	Environmental Sciences
1:00pm – 5:00pm	Section Breakouts	Conformity Assessment
1:00pm – 5:00pm	Section Breakouts	Construction Materials Engineering & Testing
3:00pm	Break <i>Sponsored by LGC Standards</i>	
1:00pm – 5:00pm	Exhibitor Set Up	
6:00pm – 7:30pm	Welcome Reception with Exhibitors <i>Sponsored by Pace Analytical Services</i>	

## Tuesday, September 27, 2016

7:00am	Registration Opens <i>Sponsored by Restek Corporation</i>	
7:30am – 8:30am	Networking Breakfast/Opening Session	
7:30am – 8:30am	Past Presidents Breakfast (by Invitation Only)	
8:30am – 9:45am	Keynote Presentation – Mike Amad <i>Sponsored by MilliporeSigma</i>	Aspects of Brewing Quality Control
9:00am – 10:00am	Scholarship Committee Meeting	
9:00am – 11:00am	Spouse/Guest Gathering	
9:45am – 10:45am	Earl Hess Ethics Lecture – Cora Fickinger	Creating a Culture of Ethics in the Lab
10:45am – 11:00am	Break <i>Sponsored by LGC Standards</i>	
11:00am – 12:15pm	Educational Session – Jamie Hasty	Understanding Human Resources; Everything You Need to Know for 2016
12:15pm – 1:15pm	Networking Lunch with Exhibitors <i>Sponsored by Agilent Technologies</i>	

## Schedule

12:15pm – 6:00pm	Golf Tournament	Tapawingo, Sunset Hills
1:30pm – 5:00pm	Networking Event	Anheuser–Busch Brewery and Ted Drewes
6:00pm – 10:00pm	Annual Reception and Dinner	St. Louis Cardinals Baseball Game

### Wednesday, September 28, 2016

7:00am	Registration Opens <i>Sponsored by Restek Corporation</i>	
7:00am – 8:00am	ILI Board Meeting	
7:30am – 8:30am	Networking Breakfast with Exhibitors <i>Sponsored by Perkin Elmer</i>	
8:30am – 10:00am	General Session and Keynote Speaker – Danny Creed <i>Sponsored by Thermo Fisher</i>	The 4 Levels of Customer Satisfaction
9:00am – 11:00am	Spouse/Guest Gathering	
10:00am – 10:30am	Break with Exhibitors <i>Sponsored by LGC Standards</i>	
10:30am – Noon	Educational Session – Jon Bohm	Evolve
Noon – 1:45pm	Lunch and Annual Business Meeting <i>Sponsored by Waters Corporation</i>	Dashboards and ILI presentations
1:30pm – 5:00pm	Spouse/Guest Tour	Forest Park – “Meet Me in St. Louis”
2:00pm – 4:30pm	CEO Forum – Gerhard Leubken, Jonathan Harrison, Joel Cohen <i>Sponsored by Baird</i>	
2:00pm – 4:00pm	Educational Session – Jason Greer	Diversity & The Brain – What’s Your Story?
3:15pm – 3:30pm	Break <i>Sponsored by LGC Standards</i>	
6:30pm – 10:00pm	Evening on Your Own	

### Thursday, September 29, 2016

7:00am	Registration Opens <i>Sponsored by Restek Corporation</i>	
7:30am – 8:30am	Networking Breakfast	
8:30am – 10:30am	Roundtable Workshop – Jon Bohm, Danny P. (Dan) Creed	
Noon	Checkout	



# Section Topics (subject to change)

**Monday, September 26th 1:00 pm – 5:00 pm**

## **Conformity Assessment Section (CAS)**

- 3rd Party Certifier Working Group Report
- Annual Recap and Review of Current Issues/Updates
- Outlook – Next Twelve months
- EMC Working Group Report
- New ISO/IEC 17025 - Issues/Discussion
- Webinar Updates
- SmartGrid Report
- State of the CAS - Review CAS Focus/Structure to Improve Value and Advocacy
  - Value Proposition
  - Dashboard
  - Review Executive Committee/Working Group Structure
  - Committee Representation Review and Discussion
  - Member Profile/Expectations
  - Participation/Growth – Strategies for Increasing Involvement
- Program Ideas for 2017 Policies and Practices (P2) Meeting
- Preston Millar Award Presentations

## **Construction Materials, Engineering & Testing Section (CMET)**

- Personnel Certification – NETTCP Updates
- US Army Corps of Engineers Updates
- Regional CMET Update
- Special Inspection Accreditation Discussion
- New Membership
- Peer Associations Discussion / Review
- CMET Leadership Elections for 2017-2018
- 2017 Section Goals, Value Proposition
- Program Ideas for 2017 Policies and Practices (P2) Meeting
- Preston Millar Award Presentations

### Environmental Sciences Section (ESS)

- Update on EPA Program Office Activities
  - ELAB
  - Results of Method 537 Capacity Survey
- Update/Issues on Laboratory Accreditation
  - Florida
  - California
  - New Jersey
  - TNI NGAB Issue
- ILI Activities
  - AEWG Training Program
  - New Technology Incubator Efforts
- Citizen Science Issue Discussion
- Laboratory Challenges Roundtable
- 2017 Section Goals, Value Proposition
- Program Ideas for 2017 Policies and Practices (P2) Meeting
- Preston Millar Award Presentations

### Food Sciences Section (FSS)

- FDA Update
- Report - Hill Visits with Appropriations and Authorization Staff
- CFSAN – AOAC GC-MS/MS Botanicals Study Update
- FDA-ACIL/ILI Collaboration Workshop on Sampling & Testing Methods Update
- Discussion – FSS Executive Committee and Chair / Vice Chair
- 2017 Section Goals, Value Proposition
- Program Ideas for 2017 Policies and Practices (P2) Meeting
- Preston Millar Award Presentations



# Educational Program

*Annual meeting education presented by ACIL's educational foundation*



A non-profit, 501(c)(3) scientific educational organization established in 1992, the multi-disciplined, member-driven, Independent Laboratories Institute (ILI) provides quality training for the laboratory community.

## Keynote Presentation – Aspects Of Brewing Quality Control

**Tuesday, September 27th, 8:30 am – 9:45 am**

### **Mike Amad (Retired Anheuser-Busch Brewery Beermaster)**

Michael Amad, Brewmaster (retired) at Anheuser-Busch, provides an upbeat presentation including:

- A brief review of the growth of the beer brewing industry in the United States and the consequent need for quality control of the brewing process;
- A brief overview of quality control aspects in the malting and beer brewing processes;
- An example of a traceability study;
- A comparison of process similarities in related industries; and
- Opportunities for laboratories to contact maltsters and brewers for independent analyses.

#### **About the Speaker:**



After working at Anheuser-Busch for over 30 years, one could say **Mike Amad** knows a little something about beer. Working in many direct production positions in several of Anheuser-Busch's breweries, Mike developed a strong understanding of the brewing industry. He served as a member of the taste panel throughout his entire career and assisted in developing the Budweiser Mobile Beer School, the On-Premise Marketing Initiative, and the Anheuser-Busch comprehensive culinary program. Towards the end of his career at A-B, he also served as the manager of brewing education and created training courses for consumers, retailers, and wholesalers. Mike moved on from Anheuser-Busch in 2009 but was not quite ready to give up his passion for brewing just yet. Since then, he has stayed involved with Anheuser-Busch, Boston Beer Company, the Master Brewers

Association of the Americas' "Beer Steward Program", and with local beer wholesalers and retailers, by working as a freelance Beermaster consultant and educator. Mike is known for his fun and engaging style of teaching and for his ability to use all of the senses to capture his audience's attention.

## Earl Hess Ethics Series – Creating a Culture of Ethics in the Lab

Tuesday, September 27th, 9:45 am – 10:45 am

### **Cora Fickinger** (*President, ATD, St. Louis Chapter*)

The required preventions are in place – ethics training for new employees, annual data integrity training, confidential reporting of possible improper practices, confidential investigations, etc. Still every year we hear about new cases of laboratory fraud. Is there something more we should be doing to prevent ethical infractions in our labs?

This session will help you to improve the ethical culture of your organization and get to the heart of what ethical decision making means. In this interactive session, we will take a look at some of the factors that threaten wise decision making and discuss what we can do to avoid them.

This presentation will focus on the following:

- Aligning your training with your company values
- Designing ethics training sessions that make an impact
- Making the right choices under stress
- Creating an ethical culture for the entire organization

#### **About the Speaker:**



**Cora Fickinger** is a workforce educator in the environmental testing industry, with four decades of experience in performance management and leadership development. She has been a member of the American Society for Testing Materials since 1974 and has received its Standards Development Award in recognition of her contribution to the validation of many international water testing standards that monitor water quality around the world.

Cora started her career with 19 years of service to the Peabody Coal Company at their corporate laboratory in Freeburg, IL. She has remained in the environmental testing industry for the past 21 years; working with Teklab, Inc. a full service environmental testing lab located in Collinsville, IL. As Quality Training Officer at Teklab, Cora is in charge of ethics, quality, GLP, and safety training. Her role at Teklab also involves new employee recruitment and on-boarding for their corporate headquarters in Collinsville and service centers covering the Kansas City, Springfield, IL and Chicago Metro areas.

Cora holds a Bachelor of Science degree in Workforce Education and Development, a Professional Coaching Certification, and is a certified facilitator with FranklinCovey. She is the President of the ATD St. Louis Chapter. The Association for Talent Development (ATD) is a professional membership organization supporting those who develop the knowledge and skills of employees in organizations around the world. The association was previously known as the American Society for Training & Development (ASTD). The vision of ATD is to create a world that works better with a mission of empowering professionals to develop talent in the workplace.

## Educational Session – Understanding Human Resources: Everything You Need to Know for 2016

Tuesday, September 27th 11:00 am – 12:15 pm

### **Jamie Hasty (Vice President, SESCO Management)**

Throughout the course of the year, the Department of Labor has made sweeping changes which impact operational and Human Resource functions for organizations, both small and large. With such complex changes at every turn, Owners, Managers and Human Resource professionals are required to quickly adjust practices to be compliant. In addition to the ongoing regulatory changes, SESCO continues see organizations struggle to screen, hire and manage staff members without facing serious charges of discrimination or wrongdoing. This session will present legal and practical tips on the following:

- Discuss required changes to Wage and Hour regulations for 2016
- Review recent interpretation on OSHA guidance for restroom facilities
- Understand the National Labor Relations Board required changes to handbook policies
- Cover basics of screening, hiring and management to avoid costly litigation

#### **About the Speaker:**



Ms. **Jamie M. Hasty** is a Vice President with SESCO Management Consultants, Bristol, Tennessee and Richmond, Virginia. Jamie graduated from East Tennessee State University with a B.B.A in Human Resources Management. Her professional affiliations include Delta Sigma Pi, a professional business fraternity, the Society for Human Resource Management and various state Chambers of Commerce.

Jamie is a Generalist consultant in all areas of human resource management with specialties in affirmative action, policy development, wage and hour accounting, employment regulation compliance, training and development, compensation and performance management systems, employee satisfaction assessments, executive screening and placement, and general human resources consulting. The variety of client engagements and daily interaction over the course of Jamie's career enables her to provide practical and helpful advice and support.

She regularly conducts management training programs for clients and serves as guest speaker for state and national associations and Chambers of Commerce. Jamie is a certified trainer for Vital Learning Corporation and SESCO Leadership Institute.

### Keynote Presentation – The Four Levels of Customer Satisfaction: Building Long Term Profit through Customer Service

Wednesday, September 28th, 8:30 am – 10:00 am

#### **Danny P. (Dan) Creed (Certified Business Coach & Trainer)**

If sales are the engine that drives your business, then customer satisfaction is the fuel. Your ability to satisfy your customers is the critical determinant of your success in driving sales and growing your business. In today's competitive market place and with ever changing technology a client can replace your product for a competitive product literally in seconds.

Everything you do, or don't do for clients matters. Everything.

In this fast paced presentation, Business Coach Dan Creed will ask attendees to roll up their sleeves and dive into the untapped opportunities available through a customer satisfaction strategy as part of a strategic plan. Coach Dan will walk attendees through the **FOUR LEVELS** of **CUSTOMER SATISFACTION**, all based on the degree to which you meet customer expectations. The higher the level you achieve, the more you will build customer loyalty and the greater will be your success.

Every attendee is guaranteed to walk away with practical and immediately applicable, powerful strategies to take advantage of the often neglected art of Customer Satisfaction. We'll learn that a customer satisfaction strategy affects sales acquisition; sales retention; talent acquisition and retention; company branding; employer branding and much more.

Business Coach Dan Creed is known for his no-nonsense, street fighting approach to building and growing a business no matter the size. His presentations do not deal in theory, but in proven and profitable strategies and solutions that are easy to understand and profitable to implement.

This is a NO-MISS presentation.

#### **About the Speaker:**



Real World Business Coach **Danny Creed** is an internationally recognized Master Business Coach. His clients are legendarily successful, benefitting from his over 40 years of "street fighting business smarts", 14 successful start-up businesses and his powerful connection with world class partners and resources. Real World Business Coach Danny Creed's clients experience an ROI much greater than traditional business coaching. This "enhanced" business coaching can be a life-changing experience as Coach Dan incorporates a customized success plan for every client based on their emotional needs paired with hard line metrics.

Coach Dan has over 7,500 hours of logged coaching time with over 8,000 recommendations. Dan is the unprecedented **SIX** time winner of the **Brian Tracy Award of Sales Excellence/ FocalPoint Coaching International Coach of the Year** and winner of the inaugural FocalPoint International Business Coaching Practice of the Year.

Dan is a leading authority on business and personal development and particularly start-up businesses with a focus on strategies and skills allowing a business owner, executive, entrepreneur or professional services organization to maintain and thrive in business in any economy. Coach Dan is also a highly regarded Keynote speaker; workshop and seminar leader, corporate trainer and FocalPoint coach recruiter. Dan is an elite *Brian Tracy International Certified Sales Trainer* and a *Founding Member Trainer and Facilitator of the Brian Tracy Corporate Training* courses.



## Educational Session – Evolve

Wednesday, September 28th 10:30 am – Noon

### Jon Bohm (CEO and President, Driven Associates)

Do you how to set your lab apart from your competition and connect with your customer in a world that is changing faster than ever before? The world has completely changed how we hear and receive information. Is your message still compelling and do you know what your audience really needs and wants to hear from you?

In this interactive workshop you will learn:

- How to connect with your audience in a changing marketplace
- How to differentiate yourself from your competition
- Why customer satisfaction is ineffective and loyalty is everything
- How to create loyalty in a non-loyal marketplace
- Why being different is much more important than being better

#### About the Speaker:



**Jon Bohm** is a sought after Performance Coach, Business Coach, National Speaker, and Trainer. He is currently CEO and President of Driven Associates. Jon has been the behind the scenes coach developing the leadership abilities of countless CEO's, Managers, Entrepreneurs, and professionals. Some of the companies Jon has worked with have gone from startups to netting more than a \$100 million in 3 years, many double their profits in less than a year while living a fuller and healthier personal life at the same time. Jon has had the privilege of working with extraordinary people and organizations in sports like the AZ Cardinals, Fortune 100 companies like Intel, and entertainment companies like Caesar's Entertainment as well as 90 other industries.

Jon is an ordained minister for the last 12 years.

Jon is a cancer survivor, marathon runner, father of 3 kids and happily married to his wife Kelly. They reside in Goodyear, AZ and although Jon likes to play, he still stinks at golf.



Main aisle of the St. Louis Cathedral Basilica.

## CEO Forum – Brought to you by Baird



Wednesday, September 28th 2:00 pm – 4:30 pm

*Testing Lab and Inspection Market Overview, Industry Growth Drivers & Trends, and M&A Sector Activities*

**Jonathan Harrison** (*Managing Director, Baird Global Investment Banking*)

**Joel Cohen** (*Managing Director & Co-Head, Baird Global Industrial Group*)

### *About the Speakers:*



**Jonathan Harrison** is a Managing Director in Baird's Global Investment Banking business. He leads Baird's Technology & Services Investment Banking business in Europe and is a founding member of Baird's market leading Global Testing, Inspection, Certification and Compliance ("TICC") team. Jonathan has over 19 years of investment banking experience and has been active in the TICC sector for much of this, working with company founders, entrepreneurs, management, private equity investors and corporate entities across the globe on a variety of transactions including minority and majority capital raisings, mergers, acquisitions and divestments. Some examples of Jonathan's TICC sector deal experience over the years include:

- IPO of Bureau Veritas in France;
- Sale of founder backed Malaysian based, *Velosi* to *Applus+* of Spain;
- Sale of US private equity-backed Desert NDT to listed *Shawcor* of Canada;
- Management buy-out of Netherlands HQ'd *Kiwa* and subsequent transformational acquisition of Finnish HQ'd *Inspecta*;
- Sale of Canadian HQ'd *Maxxam* (twice – once to a private equity investor and subsequently to Bureau Veritas);
- Sale of 3i's Element Materials Technology to private equity firm, Bridgepoint; and
- Creation of *Edif* Group, backed by UK private equity firm Phoenix Partners, and subsequent sale to Italian RINA Group.

Prior to joining Baird, Jonathan worked at Deutsche Bank where he was responsible for the firm's Business Services franchise across EMEA. Before this, Jonathan gained experience as an auditor and an economist. He has a first class degree in Economics and a Master of Philosophy in Finance..



**Joel Cohen** is a Managing Director and Co-Head of Baird's Global Industrial Group. Joel is also a member of Baird's Fairness Opinion Committee. Joel provides M&A and financing advisory services to clients in a variety of industrial technology sectors including analytical instrumentation, process technology, automation, software and testing services. Since turning his focus on industrial technology companies 15 years ago, Joel has completed over 60 transactions representing over \$12 billion in aggregate transaction value. Prior to joining Baird in 1994, Joel was a member of Kidder, Peabody & Co.'s Investment Banking Group. Joel received his M.B.A., with high honors, from the University of Chicago Graduate School of Business and holds a B.S. in Applied Mathematics and Economics from Brown University.



## CEO Forum – continued

### *What Keeps You Up at Night and What Did You Do About It?*

#### **Gerhard Luebken (Chief Regional Officer, TUV Rheinland of North America)**

In the Testing, Inspection and Certification context in which we evolve, the core challenges we inherited relate to minimizing risk, keeping tight deadlines and matching market price. Anything that impedes us from meeting these customer needs has sleeplessness written all over it. The challenge for testing houses nowadays revolves around the fact that we are being asked to anticipate testing needs for technology that's evolving faster than standards. We also face aggressive procurement units that drive down price, compete against increasingly nimble business models and encounter scarcity of talent. Failing to account for these can have serious repercussions on our brand. This CEO Forum address will highlight the importance for labs to reinvent themselves at every turn, be this through R&D or acquisitions. It will also focus on the need for testing houses to partner with procurement and demonstrate how these can offer brand risk management. Lastly, the address will emphasize how investing in people and processes is a solid cure for insomnia.

#### **About the Speaker:**



**Gerhard Luebken** is the Chief Regional Officer at TUV Rheinland of North America. Luebken comes to North America from the Greater China region, where he most recently served as Vice President Greater China at TÜV Rheinland and managed Shanghai operations. He began his career with TÜV Rheinland in 1990 as Project Engineer and Manager. As a graduate of Advanced Technical College in Berlin, Germany, Luebken holds an engineering degree, or Dipl-Ingenieur. In 2004, he received the Magnolia Silver Award from the City of Shanghai. The award is the highest recognition for foreign citizens living in Shanghai and honors them for making significant contributions to the city's economic development, social progress and international relations and cooperation.



*A aerial view of Downtown St. Louis*



### Educational Session – Diversity & The Brain:What’s Your Story?

Wednesday, September 28th, 2:00 pm – 4:00 pm

#### Jason Greer (*President, Greer Consulting*)

The *Diversity & The Brain:What’s Your Story?* Presentation is all about removing the stigma associated with Diversity and teaching people to embrace our commonalities without focusing unnecessary attention on our differences. By tapping into our internal “stories” we begin to understand how to look beyond surface level details such as color, gender, sexual orientation, etc. By focusing in on breaking down the proverbial walls that separate us, companies and organizations will realize a greater sense of relatedness and productivity among the work force.

Jason Greer’s approach to diversity training has been described as a “complete breath of fresh air” because he expands the conversation about diversity. He inspires and challenges the audience in such a way that people walk away with a greater understanding and appreciation of our commonalities. Jason digs deep below the surface of the issues, exploring how the human brain comes pre-hard-wired to send cautionary alerts when faced with input from “others” that are not like us. Then he demonstrates how “brain chemistry isn’t destiny,” and leaves his audience with actionable steps to achieve their personal and corporate goals. It’s an uplifting session that participants reflect on for weeks and months to come!

#### About the Speaker:



**Jason Greer** is founder and President of Greer Consulting, Inc. (GCI), a Labor Management and Employee Relations Consulting firm.

Mr. Greer is also a professional speaker who combines his natural wit and storytelling ability with his experience in counseling, training and conflict resolution.

He inspires audiences, both large and small, as he speaks to managing through personal and corporate growth while maintaining an intimate connection to the human components that define us and make our respective cultures special.

Mr. Greer is widely known for his work in the area of racial reconciliation based upon his experiences as a victim of cross burnings and racial harassment by the Knights of Ku Klux Klan. This story and the resulting lessons have been given new perspective in his keynote, *Diversity & The Brain:What’s Your Story?*, wherein he champions and celebrates diversity as a means of overcoming barriers to success and experiencing the best that an organization and/or community has to offer.

### Roundtable Workshop

Thursday, September 29th, 8:30 am – 10:30 am

#### Jon Bohm (*CEO and President, Driven Associates*)

#### Danny Creed (*Certified Business Coach & Trainer*)

At this roundtable workshop, attendees discuss the challenges they face in growing their business, mitigating risk, controlling costs, while increasing profitability. Members share examples of successes and openly discuss issues, while seeking best practice guidance from other members.



# Additional Activities

## Anheuser-Busch Brewery & Ted Drewes Tour

**Tuesday, September 27th, 1:30 pm – 5:00 pm**

*(included with purchase of full or spouse registrations or can be purchased separately)*

Join your peers and enjoy an afternoon learning about the rich history of the colorful Busch family en-route to the King of Beers at a tour of the Anheuser-Busch Brewery. Situated in a 100-acre complex with over 70 red brick structures, the Brewery buildings are known for their unique architecture and several are National Historic Landmarks. During the 45-minute walking tour you will see the World Famous Clydesdales, the Beechwood Aging Cellar, and the Brew House. No visit would be complete without sampling the family of Anheuser-Busch products during the tour!

After leaving Anheuser-Busch you're in for one last sweet treat at Ted Drewes Frozen Custard, a St. Louis tradition since 1929. Enjoy a specialty "concrete" that is so thick you can turn it upside down.

## Fourth Annual Golf Tournament

**Tuesday, September 27th, 12:15 pm – 6:00 pm**

*(additional event, ticket much be purchased)*

In memory of our dedicated Food Sciences Section Chair, ACIL continues its tradition with the fourth annual Tom Zierenberg Memorial Golf Tournament at the **Tapawingo National Golf Club in Sunset Hills**. Lunch will be provided.

Tapawingo features three championship nines designed to allow the golfer to play at his or her skill level. Rivers, lakes and hardwood forests provide the ultimate golf experience with twenty-seven championship holes and a spectacular natural setting designed by one of the only five winners of golf's Grand Slam.



*Ted Drewes Ice Cream*

### Annual Reception & Dinner at the Cardinals Game

**Tuesday, September 27th, 6:00 pm**

*(included with purchase of full or spouse registrations or can be purchased separately)*

A **one of a kind** event that allows you to network with your peers, hang out with your friends, and enjoy a night at the baseball game watching one of the best teams in baseball.

### Forest Park, Meet Me In St. Louis Tour

**Wednesday, September 28th, 1:30 pm – 5:00 pm**

*(additional event, ticket much be purchased)*

#### For Spouses and Guests

Start your day with a beautiful driving overview of Forest Park. Your tour guide will highlight the history of “Meet Me in St. Louis” at Forest Park - the site of the 1904 World’s Fair and one of the largest city parks in the United States. Today, Forest Park is home to the world-renowned Saint Louis Zoo, the Saint Louis Art Museum, the Missouri History Museum, the Saint Louis Science Center and the Muny, the largest outdoor theater in the country, among other attractions.

Enjoy a visit to the Missouri History Museum at the Jefferson Memorial. Here you can explore the history of St. Louis from 1764 to the present, including the Lewis & Clark Expedition and the early days of aviation with Charles Lindbergh’s historic transatlantic flight. Next, explore the 90-acre Saint Louis Zoo. Begin at The Living World, an interactive visitor and education center. Then visit the more than 3,500 residents living in recreations of their natural habitats.

Visit the Saint Louis Art Museum where there is something for everyone from modern art to the Renaissance. Considered one of the top ten art museums in the country, there truly is something exciting around every turn. Finally, at the St. Louis Science Center adults and children alike learn of the wonders of science and technology through hands-on exhibits. While at the Science Center, you will have a chance to explore three floors of exhibits on your own.



*Watch a St. Louis Cardinals baseball game from the hotel!*

# Travel Information

## Hotel Information

### Hilton St. Louis at the Ballpark

1 South Broadway

St. Louis, Missouri 63102

Tel: +1 314 421 1776, Fax: +1 314 331 9029

### Directions

#### *From Lambert-St. Louis International Airport (14 miles)*

- Take I-70 East to Memorial Dr./Broadway Exit. Go 10 blocks and the hotel is on the right.

### Transportation Options:

- Taxi service from Lambert-St. Louis International Airport is approximately \$35.00 one-way.
- Limousine Service is approximately \$55.00 one-way
- GO BEST Express Door-to-Door Airport Shuttle Service
  - Click here (<https://gobestexpress.com/reservations?code=ACIL2016>) to reserve your airport shuttle ride to/from Lambert International Airport and your hotel. Your group has a discounted rate of \$17 each way per person. Reservations MUST be made online using the link to receive the discounted rate. Standard rates (\$22 one way) will apply for walk up reservations made on the spot

## St. Louis Attractions

- **Ballpark Village**  
St. Louis Ballpark Village is St. Louis' newest sports, bar, dining and entertainment district located between Busch Stadium and our hotel. Ballpark Village is just a few steps away, and one of the best places for food, drinks and watching sports in the entire city.
- **Gateway Arch**  
Take a 630-foot ride to the top of this world-famous stainless steel monument for the finest view in the Gateway City. Then stop by the Jefferson National Expansion Memorial to get a glimpse of where Lewis and Clark set out on their historic expedition! Visitors can also hop aboard a 19th century paddle-wheel boat replica for a narrated cruise down the mighty Mississippi.
- **Forest Park**  
Once home to the 1904 World's Fair, Forest Park is one of the largest urban parks in the United States. It attracts 12 million visitors a year with world-class attractions and scenic walking and biking trails. Other points of interest include the Jewel Box, a beautiful greenhouse filled with magnificent floral displays, the golf courses and the World's Fair Pavilion.
- **St. Louis Breweries**  
Take a tour of the historic Anheuser-Busch Brewery, where you can visit the Budweiser Clydesdales and sample a variety of premium brands, or check out a variety of breweries with Brewery Tours of St. Louis. For more local flavor, stop by Schlafly Bottleworks for a free brewery tour and to try a few of the 50



different styles of beer. Enjoy live music and dining at both the Bottleworks and the Schlafly Tap Room. For a taste of something new, stop by one of St. Louis' many microbreweries such as the Square One Brewery & Distillery, which opened in 2006 as the first micro-distillery restaurant in Missouri.

- **City Museum**

Explore the City Museum's unique all-ages playground filled with caves, slides and climbing apparatus made from recycled and found objects. Visitors can interact with over 10,000 sea creatures in the World Aquarium, venture through the Museum of Mirth, Mystery and Mayhem and wander through the Elmslie and Sullivan architectural exhibit. Stop in for circus-themed food, parties and educational circus classes and workshops held daily. Create your own masterpiece in Art City, take notes with the world's largest pencil and enjoy the view while grabbing a bite at The Roof Top Cantina.

- **St. Louis Science Center**

Find out what it's like to venture out into the wild, journey under the sea or fly high up in the air at the four-story Omnimax Theater, a film experience unlike any other. See a thrilling space show at the Planetarium, one of nation's leading space education facilities. Younger children will enjoy the Discovery Room filled with interactive exhibits and experiments, and visitors of all ages can explore over 700 hands-on displays including a life-sized animatronic Tyrannosaurus Rex. At Myseum, kids learn science through fun and unique exhibits like a dino-dig, vet clinic, video wall, radar slide, magnetic ball wall, giant UFO maze, plus a whole lot more.

- **Missouri Botanical Garden**

Explore 79 acres of lush gardens, landscape architecture, greenhouses and conservatories at the oldest Botanical Garden in the United States. Wander through collections of botanical and horticultural plants among beautiful fountains and statuary. Visit the Climatron for a real rainforest experience featuring magnificent waterfalls, tropical birds and exotic plants like bananas, cacao, coffee trees and orchids. Other points of interest include the serene Japanese garden and the interactive and educational Children's Garden.

- **St. Louis Zoo**

Located on 90 acres in Forest Park, the Saint Louis Zoo is home to more than 603 species of animals, many of them rare and endangered. It is one of the few free zoos in the nation and has been named #1 zoo by Zagat Survey's U.S. Family Travel Guide in association with Parenting magazine. The Zoo annually attracts three million visitors, who can see 14,840 wild animals—including the thousands of leafcutters and butterflies at the Zoo. Since its 1910 founding, the Zoo has been renowned for its beautiful naturalistic exhibits, its diverse collection of animals and its innovative approaches to animal management, wildlife conservation, research and education. The Zoo's Education Department staff—the largest among the nation's zoos—offers programs designed to help visitors of all ages and abilities learn through experience, involvement and discovery. Of the three million visitors hosted annually by the Saint Louis Zoo, approximately 1.7 million visitors interacted with an Educational Interpreter, Zoo Docent or Zookeeper who provided educational experiences and information.

## Weather

St. Louis in the fall is mild and sunny, with lower humidity. There can be periods of heavy rainfall. Peak fall foliage occurs in mid-to-late October. Some late autumns feature a period of warm weather known as Indian summer.

## Meeting Dress

The standard dress for the meeting and all events is business casual (casual wear is acceptable for offsite events, including the Annual Reception and Dinner).

# Participants

**Jeff Abels**

Foreign Trade Service Corp.  
614 Frelinghuysen Ave  
Newark, NJ 07114  
(609) 577-1250  
jeff@ftslabs.com

**Richard Allen**

Bowser Morner, Inc.  
4518 Taylorsville Road  
Dayton, OH 45401  
(419) 691-4800  
rallen@bowser-morner.com

**Thomas Berg**

Minnesota Valley Testing Labs, Inc.  
1126 North Front Street  
New Ulm, MN 56073  
(507) 354-8517  
tberg@mvtl.com

**Dan Biggs**

Thermo Fisher Scientific  
300 Industry Drive  
Pittsburgh, PA 15275  
(828) 273-1569  
dan.biggs@thermofisher.com

**Steven Bowser**

Bowser Morner, Inc.  
4518 Taylorsville Road  
Dayton, OH 45401  
(937) 236-8805  
sbowser@bowser-morner.com

**Trevor Boyce**

Microbac Laboratories, Inc.  
101 Bellevue Road  
Pittsburgh, PA 15229  
(757) 868-4072  
trevor.boyce@microbac.com

**Michelle Briscoe**

Brooks Applied Labs  
18804 North Creek Parkway, Suite 100  
Bothell, WA 98011  
(206) 632-6206  
michelle@brooksapplied.com

**Doug Briskie**

National Technical Systems, Inc. (NTS)  
24007 Ventura Blvd, Suite 200  
Calabasas, CA 91302  
(818) 591-0776  
doug.briskie@nts.com

**Pete Brown**

LGC Standards  
276 Abby Road  
Manchester, NH 03103  
(603) 622-7660  
pete.brown@lgcgroup.com

**James Brown**

MilliporeSigma  
3050 Spruce Street  
St. Louis, MO 63103  
(314) 771-5765  
james.brown@sial.com

**Yvonne Cangelosi**

Spex Certiprep  
203 Norcross Avenue  
Metuchen, NJ 07920  
(732) 623-0420  
ycangelosi@spexcsp.com

**Annie Carter**

Brooks Applied Labs  
18804 North Creek Parkway, Suite 100  
Bothell, WA 98011  
(206) 632-6206  
sarah@brooksapplied.com

**Scot Cocanour**

Promium LLC  
3350 Monte Villa Parkway  
Bothell, WA 98021  
(425) 286-9200  
scocanour@promium.com

**Arthur G. Davies**

Simpson Gumpertz & Heger Inc.  
41 Seyon Street Building 1, Suite 500  
Waltham, MA 02453  
(781) 907-9105  
agdavies@sgh.com

**Bud Dotson**

Foreign Trade Service Corp.  
5750 N Sam Houston Parkway E,  
Suite 303  
Houston, TX 77032  
(281) 227-0541  
bud@ftslabs.com

**Cabot Earle**

Microbac Laboratories, Inc.  
101 Bellevue Road  
Pittsburgh, PA 15229  
(412) 459-1069  
cabot.earle@microbac.com

**Steven Elliott**

Materials Testing Consultants  
693 Plymouth Avenue, NE  
Grand Rapids, MI 49505  
(616) 456-5469  
sellott@mtc-test.com

**Michael Flournoy**

Eurofins Scientific, Inc.  
2200 Rittenhouse St. Suite 175  
Des Moines, IA 50321  
(425) 686-3562  
michaelflournoy@eurofinsus.com

**Eric Fox**

Anton Paar USA - ASC  
10215 Timber Ridge Drive  
Ashland, VA 23005  
(804) 550-1051  
eric.fox@anton-paar.com

**Ray Frederici**

TestAmerica  
2417 Bond Street  
University Park, IL 60484  
(708) 534-5200  
ray.frederici@testamericainc.com

# Participants

## Jay Fredkin

CABEM Technologies  
6 Lasden Brothers Way  
Franklin, MA 02038  
(508) 541-3123  
jayfredkin@cabemtechnologies.com

## Bruce Godfrey

Montrose Environmental Group  
1 Park Plaza, Suite 1000  
Irvine, CA 92614  
(510) 204-2222  
bgodfrey@montrose-env.com

## David Haataja

TUV Rheinland of N. America  
1300 Massachusetts Avenue, Suite 103  
Boxborough, MA 01719  
(978) 266-9500  
dhaataja@us.tuv.com

## Scott Hazard

O.I. Analytical  
PO Box 9010  
College Station, TX 77842-9010  
(979) 690-1711  
scott.hazard@xylem-inc.com

## Don Hobbs

LGC Standards  
276 Abby Road  
Manchester, NH 03103  
(603) 622-7660  
don.hobbs@lgcgroup.com

## Justyce Jedlicka

MilliporeSigma  
3050 Spruce Street  
St. Louis, MO 63103  
(314) 771-5765  
Justyce.jedlicka@sial.com

## Robert Johnson

Horizon Technology, Inc.  
16 Northwestern Drive  
Salem, NH 03079  
(603) 893-3663  
rsjohnson@horizontechinc.com

## David Kennedy

David Kennedy & Associates  
1583 Redford Drive Unit A  
Palm Springs, CA 92264  
(760) 992-0655  
davidkennedyassociates@msn.com

## Jeffrey King

Keystone Laboratories, Inc.  
600 E 17th Street S  
Newton, IA 50208  
(641) 792-8451  
jking@keystonelabs.com

## Michelle Kleist

Agilent Technologies, Inc.  
2850 Centerville Road  
Wilmington, DE 19808  
(302) 636-8369  
michelle.kleist@agilent.com

## Raymond Klouda

Elite Electronic Engineering  
1516 Centre Circle  
Downers Grove, IL 60515  
(630) 495-9770  
rjklouda@elitetest.com

## Joe Konschnik

Restek Corporation  
110 Benner Circle  
Bellefonte, PA 16823  
(302) 838-5796  
joe.konschnik@restek.com

## Steven Koster

Washington Laboratories, Ltd.  
7560 Lindbergh Drive  
Gaithersburg, MD 20879  
(301) 216-1500  
Stevek@wll.com

## Mary K. Krogull

Eurofins Scientific, Inc.  
2200 Rittenhouse St. Suite 175  
Des Moines, IA 50321  
(515) 362-5910  
marykaykrogull@eurofinsus.com

## Steve Kuchenberg

MilliporeSigma  
3050 Spruce Street  
St. Louis, MO 63103  
(314) 771-5765  
steve.kuchenberg@sial.com

## Jim Kuhn

Atlantic Testing Laboratories  
22 Corporate Drive  
Clifton Park, NY 12065  
(518) 383-9144  
jkuhn@atlantictesting.com

## Ken Langley

Waters Corporation  
34 Maple Street  
Milford, MA 01757  
(508) 482-3212  
ken\_j\_langley@waters.com

## Sarah Leibenguth

SEAL Analytical, Inc.  
Mequon Technology Center,  
10520-C Baehr Road  
Mequon, WI 53093  
(262) 241-7900  
sleibenguth@seal-us.com

## Doug Leonard

ANSI-ASQ National Accreditation  
Board (ANAB)  
11617 Coldwater Rd., Suite 101  
Fort Wayne, IN 46845  
(260) 637-2705  
dleonard@anab.org

## Bob Lockerman

CEM Corporation  
3100 Smith Farm Road  
Matthews, NC 28104  
(704) 821-7015  
bob.lockerman@cem.com

## Gerhard Luebken

TUV Rheinland of N. America  
1300 Massachusetts Avenue, Suite 103  
Boxborough, MA 01719  
(617) 426-4888  
gluebken@us.tuv.com



## Matthew Macy

Environmental Sampling Supply (ESS)  
640 - 143rd Avenue  
San Leandro, CA 94578  
(510) 614-8312  
matthewm@essvial.com

## Craig Marvin

Agilent Technologies, Inc.  
2850 Centerville Road  
Wilmington, DE 19808  
(302) 636-8423  
craig\_marvin@agilent.com

## Michael McBride

GFS Chemicals, Inc.  
PO Box 245  
Powell, OH 43065  
(614) 224-3299  
mikem@gfscchemicals.com

## Scott McCasland

Atlantic Testing Laboratories  
22 Corporate Drive  
Clifton Park, NY 12065  
(518) 383-9144  
smccasland@atlantictesting.com

## Kevin McKeown

SPEX CERTIPREP  
203 Norcross Avenue  
Metuchen, NJ 08840  
(732) 549-7144  
kmckeown@spex.com

## Brad Meadows

BSK Associates  
1414 Stanislaus Street  
Fresno, CA 93706  
(559) 497-2888  
bmeadows@bskassociates.com

## John Mitchell

ESC Lab Sciences  
12065 Lebanon Road  
Mt. Juliet, TN 37122  
(615) 773-9653  
jmitchell@esclabsciences.com

## Judith Morgan

Pace Analytical Services  
1800 Elm Street SE  
Minneapolis, MN 55414  
(615) 347-5418  
judy.morgan@pacelabs.com

## Jim Murphy

Pickering Laboratories  
1280 Space Park Way  
Mountain View, CA 94043  
(650) 694-6700  
jmurphy@pickeringlabs.com

## Sarah Owen

UL LLC  
1850 M Street NW, Suite 1000  
Washington, DC 20036  
(202) 530-6163  
sarah.owen@ul.com

## Brad Pieper

Microbiologics  
200 Cooper Avenue North  
St Cloud, MN 56303  
(320) 253-7400  
bpieper@microbiologics.com

## Agustin Pierri

Weck Laboratories, Inc.  
14859 East Clark Avenue  
City of Industry, CA 91745  
(626) 336-2139  
agustin.pierri@wecklabs.com

## Richard Plant

American Interplex Corporation  
8600 Kanis Road  
Little Rock, AR 72204  
(501) 224-5060  
rplant@americaninterplex.com

## David Potpink

National Technical Systems, Inc. (NTS)  
36 Gilbert Street South  
Tinton Falls, NJ 07724  
(732) 936-0800  
david.potpinka@nts.com

## Daniel Prince

Gibraltar Laboratories, Inc.  
122 Fairfield Road  
Fairfield, NJ 07004  
(973) 227-6882  
danielprince@gibraltarlabsinc.com

## Kunal Rehani

MilliporeSigma  
3050 Spruce Street  
St. Louis, MO 63103  
(314) 771-5765  
Kunal.rehani@sial.com

## Lars Reimann

Eurofins Scientific, Inc.  
2200 Rittenhouse St. Suite 175  
Des Moines, IA 50321  
(901) 301-8425  
larsreimann@eurofinsus.com

## Richard Reitz

Retlif Testing Laboratories  
3131 Detwiler Road  
Harleysville, PA 19438  
(215) 256-4133  
rreitz@retlif.com

## Derwyn Reuber

CCIL  
PO Box 41027  
Ottawa, ON K1G 5K9  
(416) 233-3403  
dreuber@ccil.com

## Joe Sanderson

Aeris Scientific  
Main Street  
Louisville, CO 80027  
(360) 562-7979  
joe@aerisscientific.com

## Gregory Schmidt

GeoTest, Inc.  
2135 South 116th Street  
West Allis, WI 53227  
(414) 321-8378  
gschmidt@888geotest.com

# Participants

## **Peter Schulert**

ESC Lab Sciences  
12065 Lebanon Road  
Mt. Juliet, TN 37122  
(615) 773-9660  
pschulert@esclabsciences.com

## **Jerry Singh**

RTI Laboratories, Inc.  
33080 Industrial Road  
Livonia, MI 48150  
(734) 422-8000  
jsingh@rtilab.com

## **Rebecca Smith**

Pickering Laboratories  
1280 Space Park Way  
Mountain View, CA 94043  
(650) 694-6700  
rlsmith@pickeringlabs.com

## **Lucas Smith**

Teledyne Advanced Chemistry  
Systems (TACS)  
4736 Socialville Foster Road  
Mason, OH 45040  
(402) 738-5411  
lucas.smith@teledyne.com

## **David Speis**

Eurofins QC, Inc.  
1205 Industrial Boulevard  
Southampton, PA 18966  
(215) 355-3900  
davidspeis@eurofinsus.com

## **Trent Sprenkle**

Restek Corporation  
110 Benner Circle  
Bellefonte, PA 16823  
(814) 353-1300  
trent.sprenkle@restek.com

## **Wade Stephenson**

EST Analytical  
503 Commercial Drive  
Fairfield, OH 45014  
(804) 245-9573  
wadestephenson@verizon.net

## **John Szpylka**

Merieux NutriSciences  
111 East Wacker Drive  
Chicago, IL 60691  
(312) 938-5151  
john.szpylka@mxns.com

## **Rachel Timmerman**

SEAL Analytical, Inc.  
Mequon Technology Center,  
10520-C Baehr Road  
Mequon, WI 53092  
(262) 241-7900  
rtimmerman@seal-us.com

## **Steve Vanderboom**

Pace Analytical Services  
1800 Elm Street SE  
Minneapolis, MN 55414  
(612) 607-6409  
steve.vanderboom@pacelabs.com

## **Steve Vincent**

Laboratory Science Institute  
PO Box 1005  
Longview, WA 98632  
(360) 430-5338  
vincent.labscience@gmail.com

## **Ann Weeks**

UL LLC  
1850 M Street, NW, Suite 1000  
Washington, DC 20036  
(202) 296-1435  
Ann.Weeks@ul.com

## **Scott Wentworth**

Retlif Testing Laboratories  
795 Marconi Avenue  
Ronkonkoma, NY 11779  
(603) 497-4600  
swentworth@retlif.com

## **Cheryl Wilkerson**

ElmTree System  
3400 North Lincoln Boulevard  
Oklahoma City, OK 73105  
(405) 606-8661  
cwilkerson@elmtreesystem.com

## **Ed Wilson**

Ed Wilson, Inc.  
1853 North Summit Avenue  
Pasadena, CA 91103  
(818) 585-0700  
eewilson818@gmail.com

## **Mike Woods**

MilliporeSigma  
3050 Spruce Street  
St. Louis, MO 63103  
(314) 771-5765  
mike.woods@sial.com

# Exhibitors

## Agilent Technologies

[www.agilent.com](http://www.agilent.com)

### Contact Attending:

Craig Marvin

[craig\\_marvin@agilent.com](mailto:craig_marvin@agilent.com)

Agilent Technologies leads the industry with robust, reliable instruments that provide the ability to analyze, confirm and quantify substances of interest. Our workflow solutions enable you to maintain stringent practices from sample preparation, through analysis, to final report. When combined with our informatics architecture, large quantities of data can be managed while preserving the integrity and security of the results. Agilent offers a complete line of GC, LC, MS and Spectroscopy instruments and technologies, as well as the related consumables, support and services.

## Anton Paar

[www.anton-paar.com](http://www.anton-paar.com)

### Contact Attending:

Eric Fox

[eric.fox@anton-paar.com](mailto:eric.fox@anton-paar.com)

Anton Paar develops, produces and distributes highly accurate laboratory instruments and process measuring systems, and provides custom-tailored automation and robotic solutions. It is the world leader in the measurement of density, concentration and CO<sub>2</sub> and in the field of rheometry. Anton Paar GmbH is owned by the charitable Santner Foundation.

## CABEM Technologies

[www.cabem.com](http://www.cabem.com)

### Contact Attending:

Jay Fredkin

[jayfredkin@cabemtechnologies.com](mailto:jayfredkin@cabemtechnologies.com)

CABEM specializes in providing, software, products and services to the testing and engineering industry. As experts in custom software and business applications, we build, deploy, integrate and maintain technology solutions for the business, academic and government communities.

## CEM Corporation

[www.cem.com](http://www.cem.com)

### Contact Attending:

Bob Lockerman

[bob.lockerman.@cem.com](mailto:bob.lockerman.@cem.com)

CEM Corporation manufactures microwave sample preparation equipment for trace metals analysis. Also for extractions for USEPA methodologies.

## ElmTree System

[www.elmtreesystem.com](http://www.elmtreesystem.com)

### Contact Attending:

Cheryl Wilkerson

[cwilkerson@elmtreesystem.com](mailto:cwilkerson@elmtreesystem.com)

The ElmTree System was developed in cooperation with Standard Testing & Engineering Co., a highly accredited Engineering Material Testing, Geotechnical and Environmental company founded in 1951. An extensive "system analysis" of the testing laboratory business and procedures identified many areas for improvement. ElmTree was designed to enable an engineering materials testing laboratory to offer the best service to their clients at a competitive price.

---

## Environmental Sampling Supply (ESS)

[www.essvial.com](http://www.essvial.com)

### Contact Attending:

Matt Macy

[matthewm@essvial.com](mailto:matthewm@essvial.com)

ESS provides a full line of Certified Clean and PrePreserved® sample containers. We also offers Soil Sampling Tools and vials for EPA Method 5035, Air Sampling Bags, Sterile Bacti-Bottles, Sampling Kits and preserved containers for Drinking Water Method UCMR 3. In addition, TOC Certified Vials and “Clean Room” containers for 1631 and Low Level metals.

---

## EST Analytical

[www.estanalytical.com](http://www.estanalytical.com)

### Contact Attending:

Wade Stephenson

[wadestephenson@verizon.net](mailto:wadestephenson@verizon.net)

EST Analytical is privately held and rapidly growing company that has become a leading Manufacturer and Distributor of analytical instrumentation including parts and consumables for laboratories around the world. They have been providing purposefully innovative solutions with best-in-class Service and Support for over 23 years in a diverse range of markets including Environmental, Petro-Chemical, Food/Flavor, and Pharmaceuticals.

---

## GFS Chemicals, Inc.

[www.gfschemicals.com](http://www.gfschemicals.com)

### Contact Attending:

Mike McBride

[mikem@gfschemicals.com](mailto:mikem@gfschemicals.com)

GFS Chemicals is a manufacturer of fine chemicals located in Columbus, Ohio since 1928. We offer over 6,000 items in our catalog, covering a wide range of laboratory needs for both analytical and research chemists. As a manufacturer, GFS understands the needs of the laboratory chemist. We provide quality products backed with technical knowledge and experience to give our customers a complete source for laboratory chemicals. Many process applications begin with the trial of our catalog sizes. We have most chemicals needed for laboratory, bench, analytical, quality control, materials characterization, scientific or research work.

---

## Horizon Technology, Inc.

[www.horizontechinc.com](http://www.horizontechinc.com)

### Contact Attending:

Robert Johnson

[rsjohnson@horizontechinc.com](mailto:rsjohnson@horizontechinc.com)

Horizon Technology is a leader in automated sample preparation systems for the analysis of semi/nonvolatile organic compounds. We offer both disk and cartridge-based extraction automation for a wide variety of applications including environmental, food safety, beverage, agriculture and more. Extract drying, evaporation/concentration and solvent recovery complete the offering. Our Oil and Grease System is the market leader. Come see our proven systems and talk about making your lab more efficient.

---

## LGC Standards

[us.lgcstandards.com](http://us.lgcstandards.com)

### Contacts Attending:

Pete Brown

[pete.brown@lgcgroup.com](mailto:pete.brown@lgcgroup.com)

Don Hobbs

[don.hobbs@lgcgroup.com](mailto:don.hobbs@lgcgroup.com)

LGC Standards is a division of the LGC Group, the UK's designated National Measurement Institute for chemical and bioanalytical measurements and an international leader in the laboratory services, measurement standards, reference materials, genomics and proficiency testing marketplaces.

**OI Analytical**[www.oico.com](http://www.oico.com)**Contact Attending:**

Scott Hazard

[Scott.hazard@xyleminc.com](mailto:Scott.hazard@xyleminc.com)

OI Analytical has been a trusted source of instrumentation for chemical analysis since 1971. We supply laboratories with selective GC detectors, custom GC/GC-MS systems, Purge-and-Trap sample concentrators for VOC analysis, TOC analyzers, automated chemistry analyzers for analysis of nutrient pollutants and cyanide, and GPC sample clean-up systems for pesticide analysis.

**PerkinElmer**[www.perkinelmer.com](http://www.perkinelmer.com)

At PerkinElmer, we are taking action to improve the health and safety of people and our environment. PerkinElmer conceives and delivers scientific solutions and services to meet our society's ever-changing needs. We are committed to transforming risk into safety, mystery into knowledge and ideas into action for a healthier today and a better tomorrow. PerkinElmer is uniquely able to meet these needs through a diverse portfolio of products such as GC, GC/MS, AA, ICP-OES, ICP-MS, Thermal Analysis, FTIR, UV-Vis, Raman, LC, and LC/MS, as well as an array of laboratory services, software, and consumables.

**Pickering Laboratories**[www.pickeringlabs.com](http://www.pickeringlabs.com)**Contacts Attending:**

Jim Murphy

[jmurphy@pickeringlabs.com](mailto:jmurphy@pickeringlabs.com)

Rebecca Smith

[rlsmith@pickeringlabs.com](mailto:rlsmith@pickeringlabs.com)

Pickering Laboratories, Inc. manufactures instruments and consumables for Sample Cleanup and Analysis in the Food & Agricultural, Environmental, Herbal Products and Clinical markets. For Sample Cleanup, we offer immunoaffinity columns for Mycotoxins, automated handling instruments for SPE columns, and the complete range of GPC Sample Cleanup instruments and columns. Common applications for GPC include the cleanup of complex matrices in the analysis of PCBs, PAHs, pesticides and more. For Analysis, we offer columns, high purity reagents, and post-column derivatizers that enable high-sensitivity with HPLC. Some common applications include Amino Acides, Carbamates, Glyphosate, Antibiotics, Biogenic Amines, Mycotoxins, Paralytic Shellfish Toxins and more.

**Promium**[www.promium.com](http://www.promium.com)**Contact Attending:**

Scot Cocunor

[scocanour@promium.com](mailto:scocanour@promium.com)

Promium provides laboratory information management systems (LIMS) that improve efficiency and increase access to analytical and operational information. Our configurable Element DataSystem® LIMS is dedicated to the needs of laboratories that test air, water/wastewater, soil and food. A unique "unified solution" with purpose-built features, Element streamlines sample management, automates report generation, and strengthens quality control.

**Restek Corporation**[www.restek.com](http://www.restek.com)**Contacts Attending:**

Joe Konshnick

[joe.konschnick@restek.com](mailto:joe.konschnick@restek.com)

Trent Sprenkle

[trent.sprenkle@restek.com](mailto:trent.sprenkle@restek.com)

Restek is a leading developer and manufacturer of chromatography products. They provide analysts around the world with the innovative tools they need to monitor the quality of air, water, soil, foods, pharmaceuticals, chemical, and petroleum products. They supply columns, standards, and accessories, manufactured under ISO 9001 certification and backed by the best service in the industry. From sample collection to preparation, from injection through separation to detection, build your liquid or gas chromatography solution with products and expertise from Restek.

### SEAL Analytical

[www.seal-analytical.com](http://www.seal-analytical.com)

**Contacts Attending:**

Rachel Timmerman

[rtimmerman@seal-us.com](mailto:rtimmerman@seal-us.com)

Sarah Leibenguth

[sleibenguth@seal-us.com](mailto:sleibenguth@seal-us.com)

SEAL Analytical is a global manufacturer & supplier of automated discrete analyzers & continuous flow analyzers for the water, wastewater, soil, plant, fertilizer, food and beverage markets. We provide genuine parts and consumables and services and support for AA1, AA3 QuAAtro, & TrAAcs (formerly Technicon) analyzers & the SEAL AQ1 and AQ2 analyzers.

### SPEX CertiPrep

[www.spexcsp.com](http://www.spexcsp.com)

**Contacts Attending:**

Yvonne Cangelosi

[Ycangelosi@spex.com](mailto:Ycangelosi@spex.com)

Kevin McKeown

[kmckeown@sepx.com](mailto:kmckeown@sepx.com)

Since 1954, SPEX CertiPrep has manufactured superior quality Certified Reference Materials (CRM) and calibration standards for analytical spectroscopy and chromatography. We offer a full range of inorganic and organic CRMs used around the world. For almost 60 years, we have provided chemists, analysts and environmental scientists products that exhibit quality, reliability and convenience. Certified by UL\_DQS for ISO 9001:2008 and accredited by A2LA under ISO 17025:2005 and ISO Guide 34-2009, the scope of our accreditation is the most comprehensive in the industry and encompasses all our manufactured products.

### Teledyne Advanced Chemistry Systems (TACS)

[www.teledyneacs.com](http://www.teledyneacs.com)

**Contact Attending:**

Lucas Smith

[lucas.smith@teledyne.com](mailto:lucas.smith@teledyne.com)

Teledyne is a company of scientists, engineers, and service professionals that are truly passionate about what they do, and that's atomic spectroscopy. Producing world-class instruments for elemental analysis is their mission. Their goal - through continuous innovation, dedication, and fresh thinking - is to constantly raise the bar, providing scientists and analysts with cutting edge instruments that deliver extraordinary results.

### Thermo Fisher Scientific

[www.thermofisher.com](http://www.thermofisher.com)

**Contact Attending:**

Dan Biggs

[dan.biggs@thermofisher.com](mailto:dan.biggs@thermofisher.com)

Thermo Fisher Scientific Inc.'s mission is to enable our customers to make the world healthier, cleaner and safer. We help our customers accelerate life sciences research, solve complex analytical challenges, improve patient diagnostics and increase laboratory productivity. Through our premier brands – Thermo Scientific, Applied Biosystems, Invitrogen, Fisher Scientific and Unity Lab Services – we offer a combination of innovative technologies, purchasing convenience and comprehensive support.

### Waters Corporation

[www.waters.com](http://www.waters.com)

**Contact Attending:**

Ken Langley

[ken\\_j\\_langley@waters.com](mailto:ken_j_langley@waters.com)

Waters is a leader in developing food testing systems that integrate column & sample prep chemistries, analytical instrumentation and data management software. Waters also thoroughly understands the specialized needs of environmental testing laboratories. Our system solutions include LC columns & sample preparation, environmental standards, chromatography, mass spectrometry and software.



## Thank You Industry Sponsors



**Agilent Technologies**

**ThermoFisher**  
SCIENTIFIC

The world leader in serving science

**Waters**

THE SCIENCE OF  
WHAT'S POSSIBLE.™

## Friends of ACIL



**PerkinElmer**  
*For the Better*



*The Climatron at the Missouri Botanical Gardens*



# ***Save the Date!***

## **2017 P2 Conference**

The Washington Court Hotel,  
Washington, DC

### **April 19 – 21, 2017**





The world leader in serving science

A proud member  
and supporter of  
**ACIL**

**Delivering value to independent laboratories**

- Expertise and capabilities to support method development and optimization
- Deep regulatory compliance knowledge and expertise
- Custom, rapid response capabilities

For more information, visit us at [www.thermofisher.com](http://www.thermofisher.com)

**ThermoFisher**  
SCIENTIFIC



Whether your challenges are sample preparation, sampling or analysis Teledyne Advanced Chemistry Systems Group can help you enhance your laboratory's productivity and its ability to produce high quality results.



### Sample Prep Systems

VOC Purge & Trap Concentrators • VOC Headspace Systems • SVOC Automated QuEChERS System Automated TOC Analyzers • UV/Persulfate Oxidation • Combustion/Total Nitrogen



### Analyzing

Inorganics/Metals by ICP • Mercury in Liquids and Solids by CVAA or CVAE • Trace Impurities in Metals/Solids by DC Arc



### Sample Introduction and Sample Handling Equipment

Automation Solutions • Laser Ablation for elemental analysis • Nebulizers for ICP-AES and ICP-MS • Sample Preparation



[www.teledyneacs.com](http://www.teledyneacs.com)

## ADVANCED DISCRETE NUTRIENT ANALYSIS

# AQ400

$\text{NH}_3$ ,  $\text{NO}_3$ ,  $\text{PO}_4$ ,  
TKN, Cl and more

*Fast unattended  
operation*

*ISO/EPS/ASTM  
standards*

*For a nutrient analyzer  
to suit your needs, call  
262-241-7900 or visit  
[www.seal-analytical.com](http://www.seal-analytical.com)*

**SEAL**  
Analytical



A Global Manufacturer  
of High Quality Sample  
Introduction Instruments



**What you do is what we make.**

8260 | 8270 | 524.2 | 524.3 | 524.4 | 624 | Liquid Injection | Headspace | SPME | Dissolved Gas Analysis | BTEX | DRO | GRO

**CENTURION**   
PURGE AND TRAP AUTOSAMPLER



**EVOLUTION**   
PURGE AND TRAP CONCENTRATOR



**LGX-50**   
LIQUID GAS EXTRACTOR



**FLEX**   
ROBOTIC SAMPLING PLATFORM



**COBRA**   
GC & GC/MS AUTOSAMPLER



**Agilent Technologies**

Channel Partner



**Agilent Technologies**

Authorized Service Provider



Simplify Synthesis



**Anton Paar**

## Monowave 50 Synthesis Reactor

Conducting sealed-tube reactions has never been easier... or more affordable. Safely run reactions at temperatures up to 250°C and 20 bar in an ultra-compact system.

Expand the scope of accessible chemistry in your lab today!



# SAFEGUARD PRECIOUS RESOURCES

Confidently safeguard our most precious resources with the widest range of high-quality, high-throughput analysis solutions for monitoring water, soil and air. Agilent Technologies combines more than 40 years of industry collaboration with the technical expertise and product leadership your lab needs to maximize uptime and reduce cost-per sample.

Agilent remains committed to developing analytical solutions that help the global scientific community protect the world's valuable environmental resources. Visit [agilent.com/chem/environmental](http://agilent.com/chem/environmental)



Visit [agilent.com/chem/enviro-compendium](http://agilent.com/chem/enviro-compendium) to download the environmental applications compendium.

© Agilent Technologies, Inc. 2016



Looking for Standards? Look no further...  
SPEX CertiPrep has what you need!



SPEX CertiPrep was founded in 1954 to provide superior Certified Reference Materials (CRMs) for Spectroscopy and Chromatography. We have a full line of AA, IC, ICP, ICP-MS, GC, GC/MS, HPLC and LC/MS standards in addition to many other products that are used in laboratories around the world. Our product lines include standards for all of the most commonly used environmental testing methods. All of our standards are manufactured from the highest purity materials and rigorously tested to comply with the highest certification levels for Certified Reference Materials. SPEX CertiPrep's scope of accreditations is the most comprehensive in the industry.

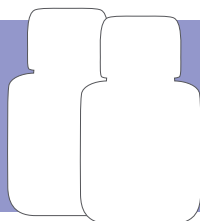

### Inorganic Certified Reference Materials for

ICP-MS | ICP | IC  
AA | LC-ICP-MS



### Organic Certified Reference Materials for

LC/MS | HPLC  
GC/MS | GC



**SPEX CertiPrep**

203 Norcross Avenue • Metuchen, NJ 08840

Tel: 1.800.LAB.SPEX • Fax: 732.603.9647 • CRMSales@spex.com • www.spexcertiprep.com



Quality analytical reagents and reference materials you can trust.  
Manufactured in Columbus, OH since 1928.  
Great products ♦ Fast delivery ♦ Service excellence



Stable, non-hazardous Primary Standards  
for the calibration of turbidity sensors



Reference Materials for the validation  
of UV-Vis spectrophotometers



### ISO 17025 Accredited

American Association for Laboratory  
Accreditation has awarded GFS with  
ISO/IEC 17025:2005 accreditation  
for the test methods for AMCO Clear®,  
In-Spec®, pH buffer solutions and  
conductivity standards



For the highest purity Acids, Solvents and Primary Standard Salts

GFS Chemicals, Inc. • [www.gfschemicals.com](http://www.gfschemicals.com) • (800) 858-9682



# Replace thousands of paper CoCs with one online service.

**EnviroChain**® online chain of custody.

From the field to the lab, EnviroChain saves you money  
while improving efficiency, accuracy and reliability.

LEARN MORE AND DOWNLOAD MOBILE APP:  
[www.promium.com/envirochain](http://www.promium.com/envirochain)

**PR̄MIUM**



## **PINNACLE PCX** ( Reliably Sensitive )

Glyphosate Analysis in Food  
The Experts for 30 Years

[www.pickeringlabs.com](http://www.pickeringlabs.com)

**PICKERING**  
LABORATORIES

CATALYST FOR SUCCESS





**EVERY DAY WE MAKE  
A DIFFERENCE IN  
ENVIRONMENTAL TESTING**



**Fresher Air**

The EXPERTS in air analysis: Enjoy Speed, Accuracy, Precision and Ease of Use. Solutions for 325, TO-17, TO-15, Soil Gas, MGP sites, Indoor/outdoor air, and more ...



**Cleaner  
Water**

We offer the most reliable technologies to detect contaminants in all environmental matrices with a focus on Performance, Quality, Instrument Uptime, Productivity, Return On Investment, and more ...



**Safer Soil**

Our instruments are designed to help you detect very low environmental concentrations of compounds to ensure regulatory requirements are met, and so are the needs of your customers.



**Claruss SQ8 GC/MS (Organics)**



**The Altus A-30 UPLC (Organics)**



**Nexlon ICP-MS (metals)**

# Organic Sample Preparation

## Get off to a Better Start with Automated Sample Prep from Horizon Technology

Horizon Technology is a leader in automated sample preparation systems for the analysis of semi/nonvolatile organic compounds. We offer both disk and cartridge based extraction automation for a wide variety of applications including environmental, food safety, clinical, toxicology and more. Completing the offering are extract drying, evaporation/concentration and solvent recovery. Our hexane-extractable (Oil & Grease) system is the market leader. Talk to us about making your lab more efficient!



PREPARE FOR BETTER RESULTS

For more info contact [sales@horizontechinc.com](mailto:sales@horizontechinc.com) or visit us at [www.horizontechinc.com](http://www.horizontechinc.com) • +1 603.893.3663



**WHAT DO  
YOU WANT TO  
ANALYZE  
TODAY?**

The brands of Xylem offer a wide variety of innovative solutions for testing and analysis. Visit our booth to learn more about our complete line of laboratory instrumentation.

[www.oico.com](http://www.oico.com)

xylem

# OSHA GHS Compliant Labels



ESS, the company that introduced PrePreserved® Containers is in full compliance with OSHA rule 29 CFR 1910.1200.

All six **GHS\* Elements** (\*Globally Harmonized System) are included on attached labels;

- Product Identifier
- Signal Word
- Hazard Statement
- Hazardous Pictograms
- Precautionary Statement
- Emergency Phone Number

Visit our website or  
call for more information  
on additional products & services  
[www.essvial.com](http://www.essvial.com)  
800.233.8425

All Elements accompany our ESS Sample Label for 40 mL vial products.



**ENVIRONMENTAL SAMPLING SUPPLY**

OAKLAND • HOUSTON • CHICAGO • RICHMOND



## CRMs and proficiency testing for food and environmental analysis

Visit Booth 4 at ACIL to find simple solutions to analytical challenges

- ✓ Single & multi-element inorganic standards
- ✓ Neats, solutions and mixes for pesticide residue analysis
- ✓ Food and beverage matrix RMs
- ✓ Proficiency testing for food and environment

[www.lgcstandards.com](http://www.lgcstandards.com) • **Science** for a safer world

**LGC Quality** - ISO 9001 • ISO/IEC 17025 • ISO Guide 34 • ISO/IEC 17043



**TIME  
MANAGEMENT**

**PRODUCTIVITY**

**EFFICIENCY**

**EFFECTIVENESS**

**iLink**  
Remote  
Laboratory  
Technology

SIMPLE TO USE  
MULTIPLE UNITS  
WIRELESS CONTROL  
REPORT PROCESSING  
REAL-TIME MONITORING  
METHOD DEVELOPMENT  
APP-BASED TECHNOLOGY

CONTACT US  
TODAY TO FIND  
OUT HOW WE CAN  
HELP YOUR LAB  
ACHIEVE IT'S GOALS.

**CEM**  
www.cem.com



 **ELMTREE**  
SYSTEM

Manage your business with  
**ONE SYSTEM** that will provide  
**all the solutions!**

Field Data Collection  
Laboratory Management  
Document Management  
Digital Signatures  
*and much more!*

*Stop by our table and say hello!*

**ElmTreeSystem.com**



WATERS  
HELPS ENSURE  
THE QUALITY  
& SAFETY  
OF FOOD AND  
BEVERAGES.

See What's Possible

Waters

THE SCIENCE OF WHAT'S POSSIBLE.®





the  
**CABEM Competency Manager**

### Built in Learning Management System (LMS)

Create training modules, upload videos, presentations, and documents, and create tests with the built in LMS. Users are rewarded with certificates after successfully completing a training module

### Gap Analysis

Quickly identify the skills, qualifications, and attributes required for employees to meet new roles, or roles that the employee aspires to reach.

### Risk Analysis

Identify the risk associated with each employee competency and determine what requires immediate attention. This feature helps address risk requirements within regulated industries.

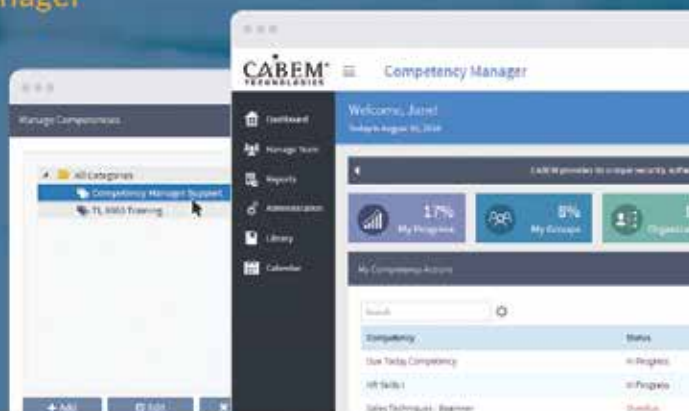

### Information Security

- Risk evaluation, analysis, and mitigation plan development
- Standards and security system evaluation and compliance
- Risk mitigation, consultation and implementation
- Continuous monitoring and system diligence services



### Custom Software Solutions

- Design, develop, and test your custom application
- Business analysis and requirements documentation
- Deploy, maintain, and enhance
- Windows or Unix/Linux domain

"Software Solutions to Advance Your Business"

CABEM Technologies, LLC | Newton, MA | (617) 244-6609 | [www.cabem.com](http://www.cabem.com)



## Chromatography is what we do and who we are.

We are an independent, international, and diverse team of employee-owners not bound to a specific brand of instrument or geographic region. We live and breathe phase chemistry, peak separations, resolution, and inertness because while chromatography may be a necessary tool in your business, it is our business. And it is a business that we directly serve across 100+ countries and six continents with unrivaled Plus 1 service, applications, and expertise. From LC and GC columns to sample prep, reference standards to accessories, Restek is your first and best choice for chromatography.



[www.restek.com](http://www.restek.com)



# Hotel Map

## Lobby Level

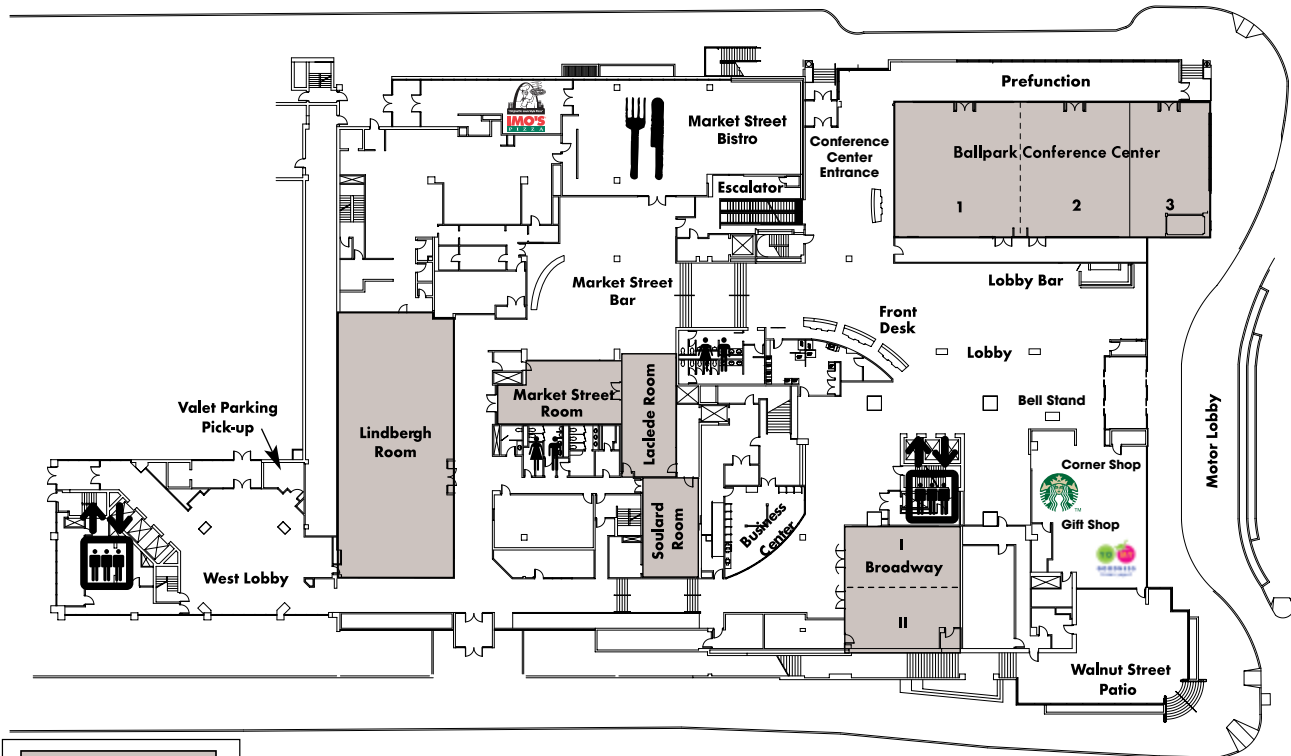

## Second Floor Convention Level

**THREE SIXTY**  
SIP SEE SAVOR

**26th Floor  
Rooftop Bar**

**Board Room** and **Manchester Room**

**Fourth Floor  
West Tower**

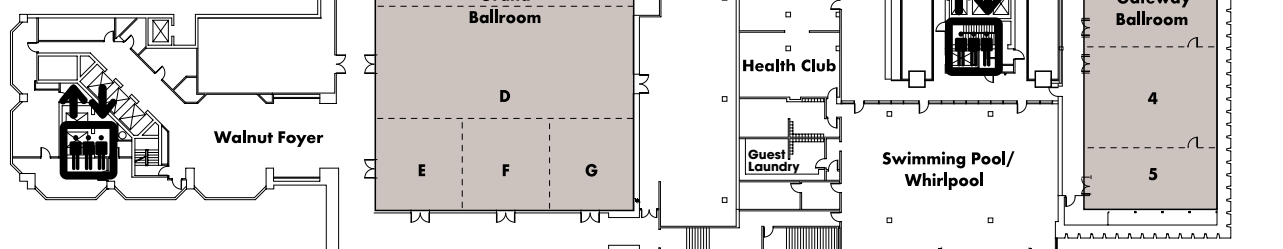



# *Save the Date!*

80th Annual Meeting

Portland, OR

October 2-5, 2017

The Benson Hotel

